

LEAD-LINED SOLID CORE WOOD DOORS

MAYCO Industries lead core doors are manufactured to special order, with lead thickness from 1/32" to 1/2". A continuous lead sheet is placed in the center of a divided wood core and securely fastened with lead covered bolts. Bolt free areas at each corner and in the center of each side provide space for hardware attachment.



Our standard wood veneers include Plain Sliced Red Oak, Rotary Cut Red Oak, Rotary Cut Birch, and Rift Cut White Oak. Many other veneers are available upon request. Plastic laminates complete with edge strips are also available.

We can machine door slabs for almost any hardware as long as it is compatible with the lead core. This includes cylindrical and mortised locksets, butt hinges, pivot hinges, flush bolts, automatic door bottoms and many more. Our standard undercut is 1/8" on each side of the door, 1/8" at the top of the door, and 1/2" at the bottom of the door. Lead lined astragals are included with double door sets.

Hollow Metal Door lite kits are available as is lead oxide glass with either a 1/16" or a 1/8" lead equivalency. Door hardware can also be purchased directly from MAYCO Industries.

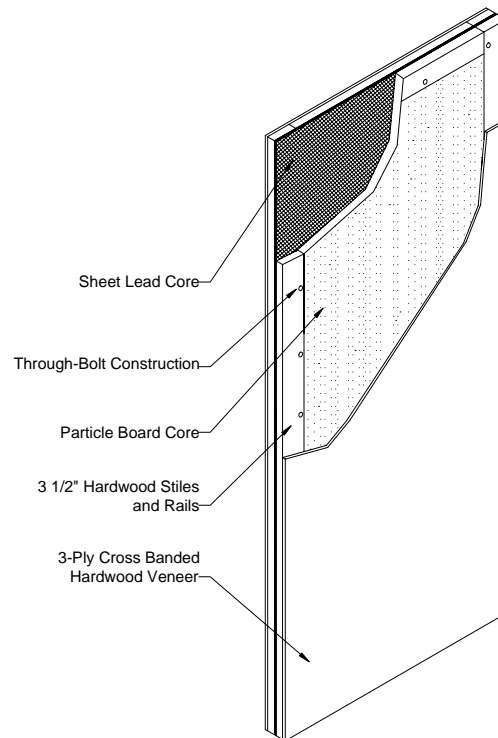

DOOR SWING

FACING DOOR FROM THE CORRIDOR

